

## <strong>Couplings for drinking water</strong>

Storz couplings for hoses for transport of drinking water. The surfaces of the aluminium couplings are equipped with tin coating which is known in the drinking water field for years. For this tin coating we dispose of a confirmation of operation for drinking water applications of the DVGW-Authority TZW Karlsruhe which is equivalent to DIN 50930-6. DVGW-examined Storz seals and gaskets with KTW D1/D2 as well as W270-DVGW-release.

### Hose couplings



1001

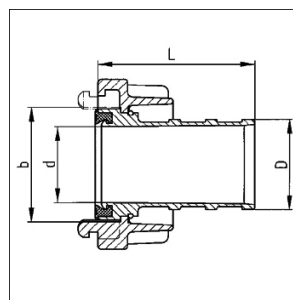

1001

Nominal size	Lug spacing (mm)	For hose i. d. (mm)	Length tail piece L (mm)	Inside dia. (mm)	Weight (kg)	Ident.-No.	Remarks
25=D-DS	31	25	53	18	0,090	40244485	
38-DS	51	38	90	30	0,210	60003385	
52=C	66	42	55	36	0,340	40266285	
52=C	66	52	55	45	0,325	40244685	
52=C-DS	66	52	90	45	0,370	40245285	
75=B	89	75	60	65	0,560	40244885	